



EXPANSION JOINT SYSTEMS FOR CONSTRUCTION INDUSTRY

You will find us on



Product Data Sheet

DURAFLEX Z 10

Aluminium / TPE expansion joint profile for installation in the floor covering (integrated)



The DURAFLEX Z 10 series expansion joint profiles have been specially developed for use inside buildings only used by pedestrians or, depending on the design, light vehicles as well. These include, for example, houses, apartments, schools or hotels. The profiles, made of aluminium with a thermoplastic elastomer insert for absorbing movement, are installed in the floor covering. Variants are available for joint widths of 30 mm - 80 mm and floor covering heights of 30 mm - 50 mm. In the Z 10RF version, the profile is available for retrofitting onto the floor covering.



Technical Properties

Item-no. Floor/Floor connection DFA Z10 .../300 Floor/Wall connection DFA Z10 ...X/300	3013 3020
Overall joint gap	30 mm
Visible width (floor/floor)	32 mm
Nominal height (h)	13 20 mm
Load bearing capacity	Pedestrian
Movement capacity	20 mm (± 10 mm)
Profile length	300 cm
Material	Aluminium, TPE
Anchorage	Every 35 cm

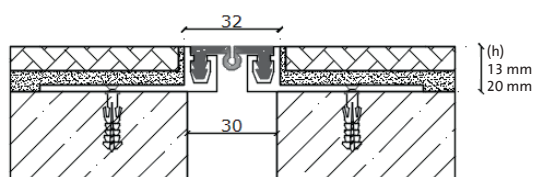

Floor/Floor connection

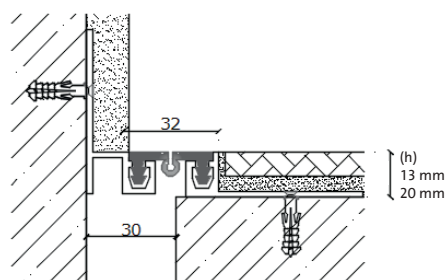

Floor/Wall connection

Indications

The following applies to all products/materials: Usability in terms of mechanical and chemical loads should be carefully checked in each case before installation.

DURAL GmbH

Südring 11

D-56412 Ruppach-Goldhausen

Tel. +49 (0) 2602/9261-0

Fax +49 (0) 2602/9261-50

info@dural.com

Product Data Sheet

DURAFLEX Z 10

Aluminium / TPE expansion joint profile for installation in the floor covering (integrated)



The DURAFLEX Z 10 series expansion joint profiles have been specially developed for use inside buildings only used by pedestrians or , depending on the design , light vehicles as well. These include, for example, houses, apartments, schools or hotels. The profiles, made of aluminium with a thermoplastic elastomer insert for absorbing movement, are installed in the floor covering. Variants are available for joint widths of 30 mm - 80 mm and floor covering heights of 30 mm - 50 mm. In the Z 10RF version, the profile is available for retrofitting onto the floor covering.



Technical Properties

Item-no.	
Floor/Floor connection	DFA Z10 .../300
Floor/Wall connection	DFA Z10 ...X/300
	3026 3035 3050
Overall joint gap	30 mm
Visible width (floor/floor)	32 mm
Nominal height (h)	26 mm 35 mm 50 mm
Load bearing capacity	Light vehicle
Movement capacity	20 mm (± 10 mm)
Profile length	300 cm
Material	Aluminium, TPE
Anchorage	Every 35 cm

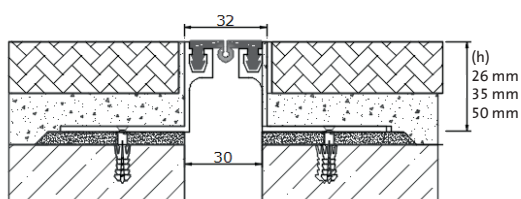

Floor/Floor connection

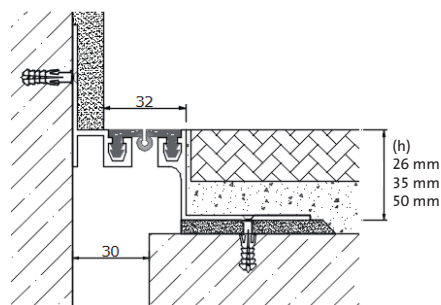

Floor/Wall connection

Indications

The following applies to all products/materials: Usability in terms of mechanical and chemical loads should be carefully checked in each case before installation.

DURAL GmbH

Südring 11

D-56412 Ruppach-Goldhausen

Tel. +49 (0) 2602/9261-0

Fax +49 (0) 2602/9261-50

info@dural.com

Product Data Sheet

DURAFLEX Z 10RF

Z 10 RF - Aluminium / TPE expansion joint profile for mounting on the floor covering

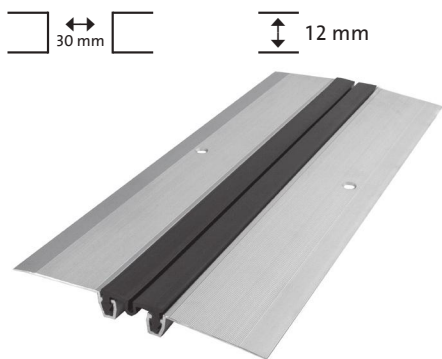

The DURAFLEX Z 10RF expansion joint profile has been specially developed for use inside buildings only used by pedestrians. These include, for example, houses, apartments, schools or hotels. The profiles, made of aluminium with a thermoplastic elastomer insert for absorbing movement, are retrofitted onto the floor covering. In the Z 10 version, the profile is available for integration into the floor covering.



Technical Properties

Item-no.		
Floor/Floor connection	DFA Z10RF .../300	3012
Floor/Wall connection	DFA Z10RF ...X/300	
Overall joint gap		30 mm
Visible width (floor/floor)		125 mm
Nominal height (h)		12 mm
Load bearing capacity		Pedestrian
Movement capacity		20 mm (± 10 mm)
Profile length		300 cm
Material		Aluminium, TPE
Anchorage		Every 35 cm

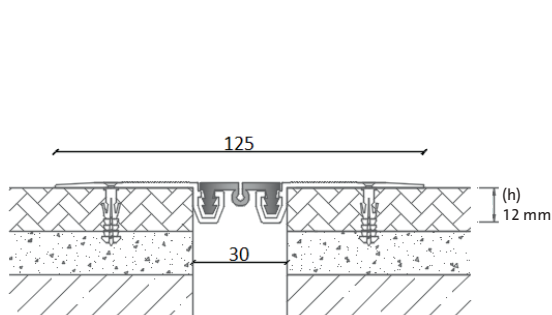

Floor/Floor connection

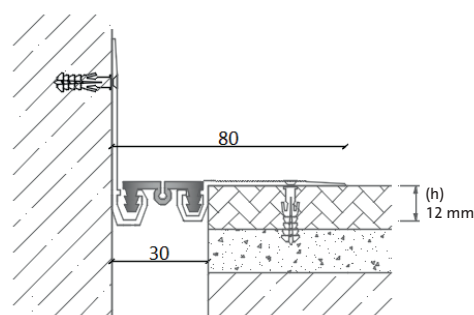

Floor/Wall connection

Indications

The following applies to all products/materials: Usability in terms of mechanical and chemical loads should be carefully checked in each case before installation.

DURAL GmbH

Südring 11
D-56412 Ruppach-Goldhausen
Tel. +49 (0) 2602/9261-0
Fax +49 (0) 2602/9261-50
info@dural.com

Product Data Sheet

DURAFLEX Z 50

Expansion joint profile made of aluminium for installation in the floor covering (integrated)



The expansion joint profiles of the DURAFLEX Z 50 series are made entirely of high quality aluminium and are designed for areas with light stress and traffic loads, including outdoors. Areas of application include floors of shopping malls, schools or hotels, but also car parks that are only used by light vehicles. The profiles are installed in the floor covering. Variants are available for floor covering heights of 28 mm - 60 mm. In version Z 50RF, the profile is available for retrofitting onto the floor covering.



Technical Properties

Item-no. Floor/Floor connection DFA Z50 .../300 Floor/Wall connection DFA Z50 ...X/300	5028
Overall joint gap	50 mm
Visible width (floor/floor)	70 mm
Nominal height (h)	28 mm
Load bearing capacity	15kN vehicle
Movement capacity	20 mm (± 10 mm)
Profile length	300 cm
Material	Aluminium
Anchorage	every 35 cm

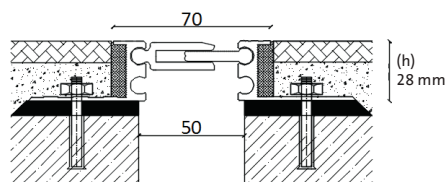

Floor/Floor connection

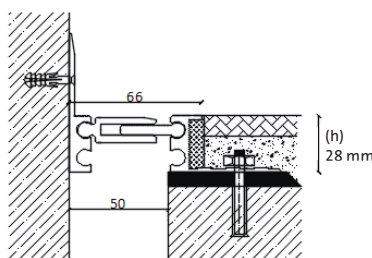

Floor/Wall connection

Indications

The following applies to all products/materials: Usability in terms of mechanical and chemical loads should be carefully checked in each case before installation.

DURAL GmbH

Südring 11

D-56412 Ruppach-Goldhausen

Tel. +49 (0) 2602/9261-0

Fax +49 (0) 2602/9261-50

info@dural.com

Product Data Sheet

DURAFLEX Z 50

Expansion joint profile made of aluminium for installation in the floor covering (integrated)

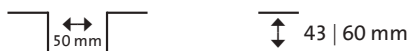

The expansion joint profiles of the DURAFLEX Z 50 series are made entirely of high quality aluminium and are designed for areas with light stress and traffic loads, including outdoors. Areas of application include floors of shopping malls, schools or hotels, but also car parks that are only used by light vehicles. The profiles are installed in the floor covering. Variants are available for floor covering heights of 28 mm - 60 mm. In version Z 50RF, the profile is available for retrofitting onto the floor covering.



Technical Properties

Item-no. Floor/Floor connection DFA Z50 .../300 Floor/Wall connection DFA Z50 ...X/300	5043 5060
Overall joint gap	50 mm
Visible width (floor/floor)	70 mm
Nominal height (h)	43 mm 60 mm
Load bearing capacity	35kN vehicle, 25kN forklift
Movement capacity	20 mm (± 10 mm)
Profile length	300 cm
Material	Aluminium
Anchorage	Every 35 cm

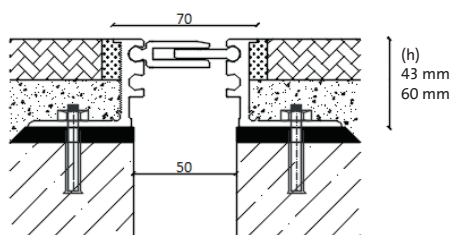

Floor/Floor connection

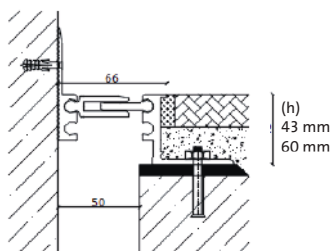

Floor/Wall connection

Indications

The following applies to all products/materials: Usability in terms of mechanical and chemical loads should be carefully checked in each case before installation.

DURAL GmbH

Südring 11

D-56412 Ruppach-Goldhausen

Tel. +49 (0) 2602/9261-0

Fax +49 (0) 2602/9261-50

info@dural.com

Product Data Sheet

DURAFLEX Z 40

Heavy duty aluminium expansion joint profile for installation in the floor covering (integrated)



The expansion joint profiles of the DURAFLEX Z 40 series are made entirely of high quality aluminium and are designed for areas with high stress and traffic loads outdoors. Fields of application are car parks as well as commercial or industrial buildings. The profiles are installed in the floor covering. Variants are available for joint widths of 50 mm and 80 mm and floor covering heights of 30 mm - 70 mm. In version Z 40RF, the profile is available for retrofitting onto the floor covering.



Technical Properties

Item-no.	
Floor/Floor connection	DFA Z40 .../400
Floor/Wall connection	DFA Z40 ...X/400
	5030 5040 5050 5060 5070
Overall joint gap	50 mm
Visible width (floor/floor)	77 mm
Nominal height (h)	30 mm 40mm 50 mm 60 mm 70 mm
Load bearing capacity	300kN vehicle, 65kN forklift
Movement capacity	20 mm (± 10 mm)
Profile length	400 cm
Material	Aluminium
Anchorage	Every 35 cm

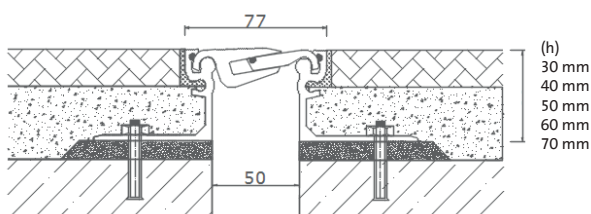

Floor/Floor connection

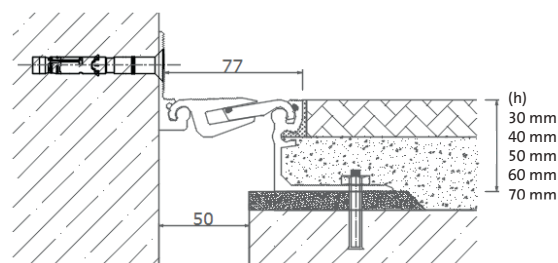

Floor/Wall connection

Indications

The following applies to all products/materials: Usability in terms of mechanical and chemical loads should be carefully checked in each case before installation.

DURAL GmbH

Südring 11

D-56412 Ruppach-Goldhausen

Tel. +49 (0) 2602/9261-0

Fax +49 (0) 2602/9261-50

info@dural.com



Product Data Sheet

DURAFLEX Z 110SI

Heavy duty expansion joint profile made of steel for retrofitting into the floor covering



The DURAFLEX Z 110SI expansion joint profile is specifically designed for heavy-duty floors in high-bay warehouses, factory or industrial buildings and other areas with heavy traffic, including outdoors. It is entirely made of steel and is inserted into the floor covering.



Technical Properties

Item-no. Floor/Floor connection DFE Z110SI .../200	5028
Overall joint gap	50 mm
Visible width (floor/floor)	200 mm
Nominal height (h)	28 mm
Load bearing capacity	600kN vehicle, 90kN forklift
Movement capacity	20 mm (± 10 mm)
Profile length	200 cm
Material	Steel
Anchorage	Every 20 cm

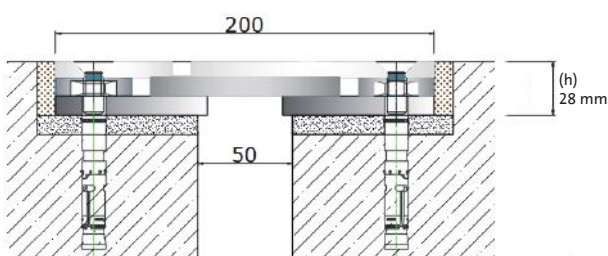

Floor/Floor connection

Indications

The following applies to all products/materials: Usability in terms of mechanical and chemical loads should be carefully checked in each case before installation.

DURAL GmbH

Südring 11
D-56412 Ruppach-Goldhausen
Tel. +49 (0) 2602/9261-0
Fax +49 (0) 2602/9261-50
info@dural.com

Product Data Sheet

DURAFLEX Z 120SI

Heavy duty expansion joint profile made of aluminium / steel for retrofitting into the floor covering



The DURAFLEX Z 120SI expansion joint profile is specifically designed for heavy-duty floors in high-bay warehouses, factory or industrial buildings and other areas with heavy traffic, including outdoors. It is made of a combination of aluminium and steel and is embedded in the floor covering.



Technical Properties

Item-no. Floor/Floor connection DFA Z120SI .../200	5030
Overall joint gap	50 mm
Visible width (floor/floor)	200 mm
Nominal height (h)	30 mm
Load bearing capacity	600kN vehicle, 90kN forklift
Movement capacity	40 mm (± 20 mm)
Profile length	200 cm
Material	Aluminium, steel
Anchorage	Every 20 cm

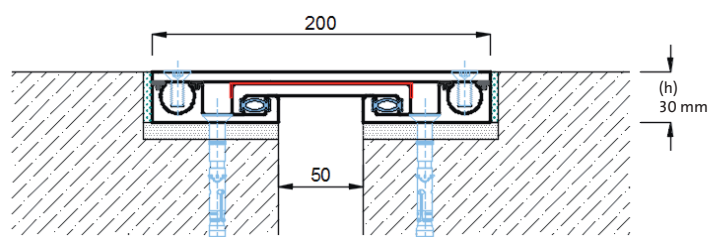

Floor/Floor connection

Indications

The following applies to all products/materials: Usability in terms of mechanical and chemical loads should be carefully checked in each case before installation.

DURAL GmbH

Südring 11
D-56412 Ruppach-Goldhausen
Tel. +49 (0) 2602/9261-0
Fax +49 (0) 2602/9261-50
info@dural.com

Product Data Sheet

DURAFLEX Z 10

Aluminium / TPE expansion joint profile for installation in the floor covering (integrated)

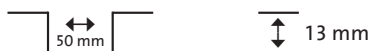

The DURAFLEX Z 10 series expansion joint profiles have been specially developed for use inside buildings only used by pedestrians or, depending on the design, light vehicles as well. These include, for example, houses, apartments, schools or hotels. The profiles, made of aluminium with a thermoplastic elastomer insert for absorbing movement, are installed in the floor covering. Variants are available for joint widths of 30 mm - 80 mm and floor covering heights of 30 mm - 50 mm. In the Z 10RF version, the profile is available for retrofitting onto the floor covering.



Technical Properties

Item-no. Floor/Floor connection DFA Z10 .../300 Floor/Wall connection DFA Z10 ...X/300	5013
Overall joint gap	50 mm
Visible width (floor/floor)	52 mm
Nominal height (h)	13 mm
Load bearing capacity	Pedestrian
Movement capacity	20 mm (± 10 mm)
Profile length	300 cm
Material	Aluminium, TPE
Anchorage	Every 35 cm

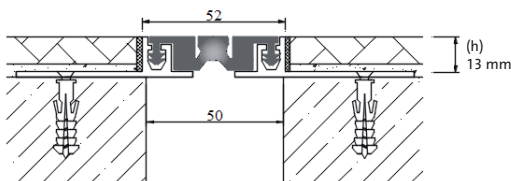

Floor/Floor connection

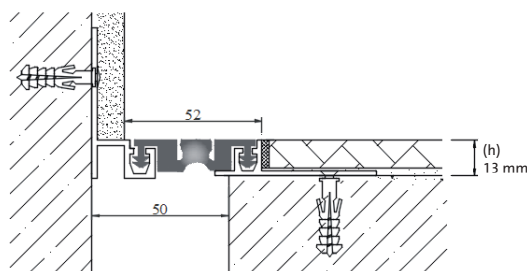

Floor/Wall connection

Indications

The following applies to all products/materials: Usability in terms of mechanical and chemical loads should be carefully checked in each case before installation.

DURAL GmbH
Südring 11
D-56412 Ruppach-Goldhausen
Tel. +49 (0) 2602/9261-0
Fax +49 (0) 2602/9261-50
info@dural.com

Product Data Sheet

DURAFLEX Z 10

Aluminium / TPE expansion joint profile for installation in the floor covering (integrated)

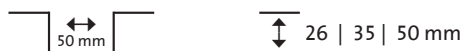

The DURAFLEX Z 10 series expansion joint profiles have been specially developed for use inside buildings only used by pedestrians or, depending on the design, light vehicles as well. These include, for example, houses, apartments, schools or hotels. The profiles, made of aluminium with a thermoplastic elastomer insert for absorbing movement, are installed in the floor covering. Variants are available for joint widths of 30 mm - 80 mm and floor covering heights of 30 mm - 50 mm. In the Z 10RF version, the profile is available for retrofitting onto the floor covering.



Technical Properties

Item-no.	
Floor/Floor connection	DFA Z10 .../300
Floor/Wall connection	DFA Z10 ...X/300
	5026 5035 5050
Overall joint gap	50 mm
Visible width (floor/floor)	52 mm
Nominal height (h)	26 mm 35 mm 50 mm
Load bearing capacity	25kN vehicle
Movement capacity	20 mm (± 10 mm)
Profile length	300 cm
Material	Aluminium, TPE
Anchorage	Every 35 cm

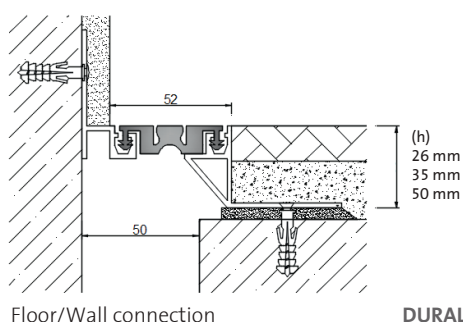
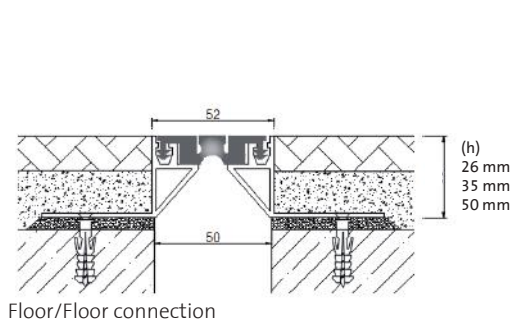

Indications

The following applies to all products/materials: Usability in terms of mechanical and chemical loads should be carefully checked in each case before installation.

DURAL GmbH
 Südring 11
 D-56412 Ruppach-Goldhausen
 Tel. +49 (0) 2602/9261-0
 Fax +49 (0) 2602/9261-50
 info@dural.com

Product Data Sheet

DURAFLEX Z 160RF

Expansion joint profile made of steel / rubber for retrofitting onto the floor covering



The DURAFLEX Z160RF expansion joint profile is a particularly flat, highly resilient system for retrofitting onto the floor covering. Fields of application are car parks, shopping malls or industrial buildings, including outdoors. The steel core is completely encased in rubber. The anchoring in the floor is unilateral.



Industrial



Heavy Vehicle



Exterior/Interior

Technical Properties

Item-no.		
Floor/Floor connection	DFR Z160RF .../200	5008
Floor/Wall connection	DFR Z160RF .../200	1008
Overall joint gap	50 mm	100 mm
Visible width (floor/floor)	200 mm	250 mm
Nominal height (h)	8 mm	8 mm
Load bearing capacity	90kN vehicle, 90kN forklift	90kN vehicle, 90kN forklift
Movement capacity	100 mm (± 50 mm)	100 mm (± 50 mm)
Profile length	200 cm	200 cm
Material	Rubber, steel	Rubber, steel
Anchorage	Every 25 cm	Every 25 cm

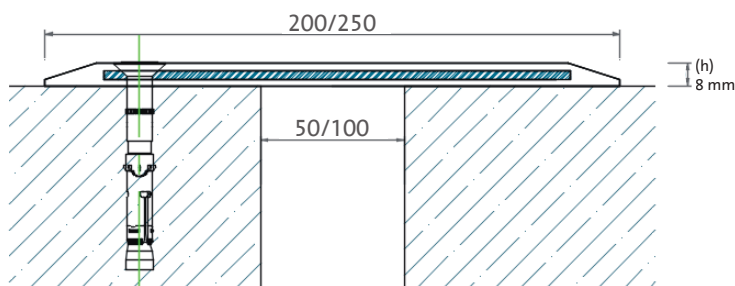

Indications

The following applies to all products/materials: Usability in terms of mechanical and chemical loads should be carefully checked in each case before installation.

DURAL GmbH

Südring 11
 D-56412 Ruppach-Goldhausen
 Tel. +49 (0) 2602/9261-0
 Fax +49 (0) 2602/9261-50
 info@dural.com

Product Data Sheet

DURAFLEX Z 130RF

Expansion joint profile made of steel / rubber for mounting on the floor covering



The DURAFLEX Z 130RF expansion joint system is designed for retrofitting on floors in shopping centres or car parks, including with heavy traffic, and also outdoors. The steel core is completely encased in rubber. It is available for different joint widths.



Technical Properties

Item-no. DFR Z130RF .../200	5035	10035
Overall joint gap	50 mm	100 mm
Visible width (floor/floor)	312 mm	362 mm
Nominal height (h)	35 mm	35 mm
Load bearing capacity	65kN vehicle	65kN vehicle
Movement capacity	50 mm (±25 mm)	100 mm (±50 mm)
Profile length	200 cm	200 cm
Material	Rubber, steel	Rubber, steel
Anchorage	Every 25 cm	Every 25 cm

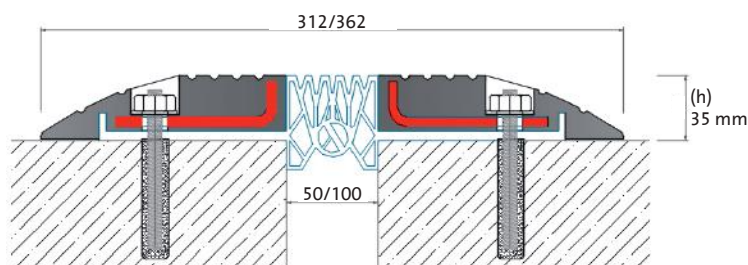

Indications

The following applies to all products/materials: Usability in terms of mechanical and chemical loads should be carefully checked in each case before installation.

DURAL GmbH

Südring 11
D-56412 Ruppach-Goldhausen
Tel. +49 (0) 2602/9261-0
Fax +49 (0) 2602/9261-50
info@dural.com

Product Data Sheet

DURAFLEX Z 40

Heavy duty aluminium expansion joint profile for installation in the floor covering (integrated)



The expansion joint profiles of the DURAFLEX Z 40 series are made entirely of high quality aluminium and are designed for areas with high stress and traffic loads outdoors. Fields of application are car parks as well as commercial or industrial buildings. The profiles are installed in the floor covering. Variants are available for joint widths of 50 mm and 80 mm and floor covering heights of 30 mm - 70 mm. In version Z 40RF, the profile is available for retrofitting onto the floor covering.



Technical Properties

Item-no.	
Floor/Floor connection DFA Z40 .../400	8030 8040 8050 8060 8070
Floor/Wall connection DFA Z40 ...X/400	
Overall joint gap	80 mm
Visible width (floor/floor)	110 mm
Nominal height (h)	30 mm 40mm 50 mm 60 mm 70 mm
Load bearing capacity	300kN vehicle, 65kN forklift
Movement capacity	32 mm (± 16 mm)
Profile length	400 cm
Material	Aluminium
Anchorage	Every 35 cm

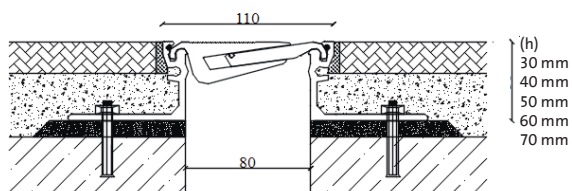

Floor/Floor connection

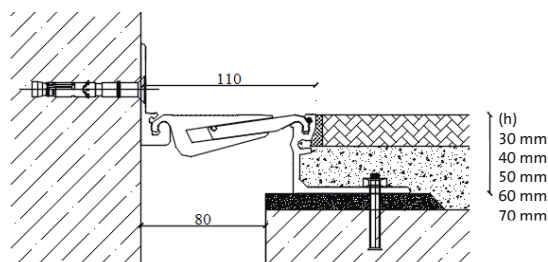

Floor/Wall connection

Indications

The following applies to all products/materials: Usability in terms of mechanical and chemical loads should be carefully checked in each case before installation.

DURAL GmbH

Südring 11

D-56412 Ruppach-Goldhausen

Tel. +49 (0) 2602/9261-0

Fax +49 (0) 2602/9261-50

info@dural.com

Product Data Sheet

DURAFLEX Z 50RF

Expansion joint profile made of aluminium for mounting on the floor covering



The DURAFLEX Z 50RF expansion joint profile is made entirely of high quality aluminium and is designed for outdoor areas with light stress and traffic loads. Areas of application include floors of shopping malls, schools or hotels, but also car parks that are only used by light vehicles. The profiles are retrofitted onto the floor covering. In version Z 50, the profile is available for integration into the floor covering.



Technical Properties

Item-no. Floor/Floor connection DFA Z50RF .../300 Floor/Wall connection DFA Z50RF ...X/300	8026
Overall joint gap	80 mm
Visible width (floor/floor)	180 mm
Nominal height (h)	26 mm
Load bearing capacity	Light vehicle
Movement capacity	24 mm (± 12 mm)
Profile length	300 cm
Material	Aluminium
Anchorage	Every 35 cm

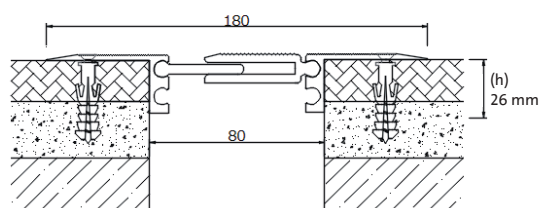

Floor/Floor connection

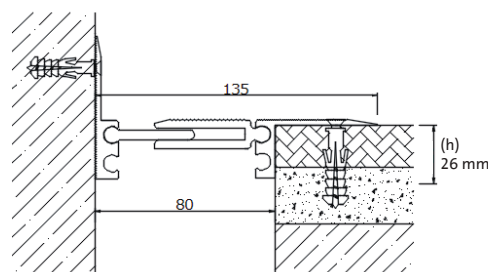

Floor/Wall connection

Indications

The following applies to all products/materials: Usability in terms of mechanical and chemical loads should be carefully checked in each case before installation.

DURAL GmbH

Südring 11
 D-56412 Ruppach-Goldhausen
 Tel. +49 (0) 2602/9261-0
 Fax +49 (0) 2602/9261-50
 info@dural.com

Product Data Sheet

DURAFLEX Z 10

Aluminium / TPE expansion joint profile for installation in the floor covering (integrated)



The DURAFLEX Z 10 series expansion joint profiles have been specially developed for use inside buildings only used by pedestrians or, depending on the design, light vehicles as well. These include, for example, houses, apartments, schools or hotels. The profiles, made of aluminium with a thermoplastic elastomer insert for absorbing movement, are installed in the floor covering. Variants are available for joint widths of 30 mm - 80 mm and floor covering heights of 30 mm - 50 mm. In the Z 10RF version, the profile is available for retrofitting onto the floor covering.



Technical Properties

Item-no. Floor/Floor connection DFA Z10 .../300 Floor/Wall connection DFA Z10 ...X/300	8030
Overall joint gap	80 mm
Visible width (floor/floor)	80 mm
Nominal height (h)	30 mm
Load bearing capacity	Pedestrian
Movement capacity	20 mm (± 10 mm)
Profile length	300 cm
Material	Aluminium, TPE
Anchorage	Every 35 cm

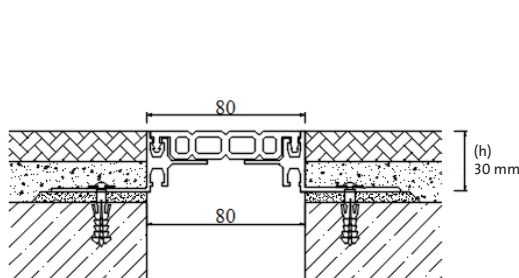

Floor/Floor connection

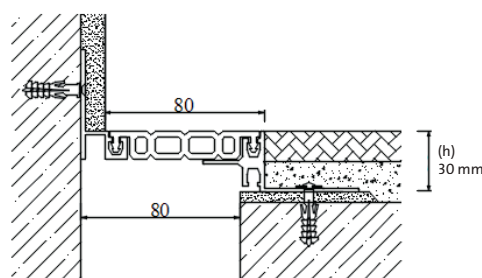

Floor/Wall connection

Indications

The following applies to all products/materials: Usability in terms of mechanical and chemical loads should be carefully checked in each case before installation.

DURAL GmbH

Südring 11

D-56412 Ruppach-Goldhausen

Tel. +49 (0) 2602/9261-0

Fax +49 (0) 2602/9261-50

info@dural.com

Product Data Sheet

DURAFLEX Z 60

Expansion joint profile made of aluminium for installation in the floor covering (integrated)



The expansion joint profiles of the DURAFLEX Z 60 series are made entirely of high quality aluminium and are designed for areas with medium loads and traffic outdoors. Fields of application are car parks as well as commercial or industrial buildings. The profiles are installed in the floor covering. Variants are available for floor covering heights of 50 mm - 90 mm.



Technical Properties

Item-no.	
Floor/Floor connection	DFA Z60 .../400
Floor/Wall connection	DFA Z60 ...X/400
	10050 10060 10070 10090
Overall joint gap	100 mm
Visible width (floor/floor)	130 mm
Nominal height (h)	50 mm 60 mm 70 mm 90 mm
Load bearing capacity	90kN vehicle, 35kN forklift
Movement capacity	36 mm (± 18 mm)
Profile length	400 cm
Material	Aluminium
Anchorage	Every 35 cm

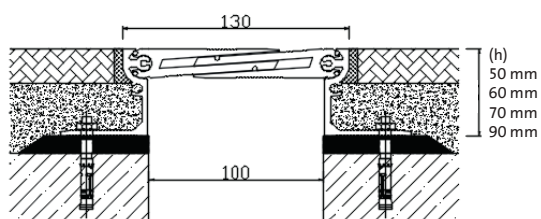

Floor/Floor connection

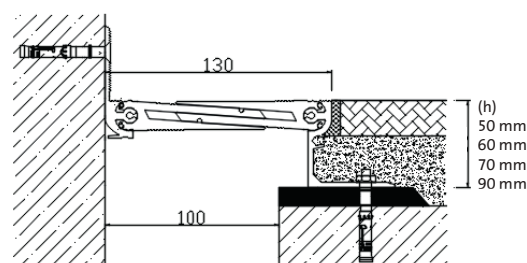

Floor/Wall connection

Indications

The following applies to all products/materials: Usability in terms of mechanical and chemical loads should be carefully checked in each case before installation.

DURAL GmbH

Südring 11
D-56412 Ruppach-Goldhausen
Tel. +49 (0) 2602/9261-0
Fax +49 (0) 2602/9261-50
info@dural.com

Product Data Sheet

DURAFLEX Z 90

Seismic expansion joint profile for installation in the floor covering (integrated)

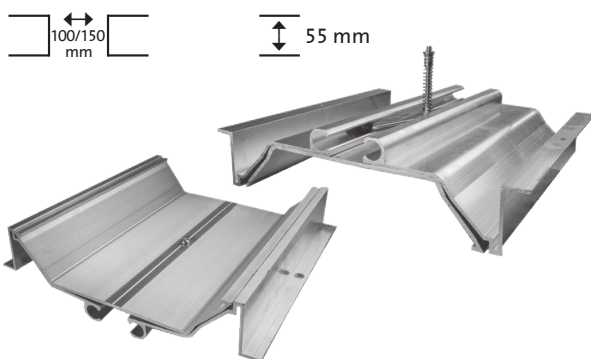

The expansion joint profiles of the DURAFLEX Z 90 series have been specially developed for use in shopping malls, houses, flats, schools, hotels and other buildings where there is a risk of seismic vibrations. The profile, made entirely of high quality aluminium, is installed in the floor covering and is designed for areas with light pedestrian loads.



Technical Properties

Item-no. DFA Z90 .../300	10055	15055
Overall joint gap	100 mm	150 mm
Visible width (floor/floor)	300 mm	350 mm
Nominal height (h)	55 mm	55 mm
Load bearing capacity	Pedestrian	Pedestrian
Movement capacity	100 mm (± 50 mm)	150 mm (± 75 mm)
Profile length	300 cm	300 cm
Material	Aluminium	Aluminium
Anchorage	Every 35 cm	Every 35 cm

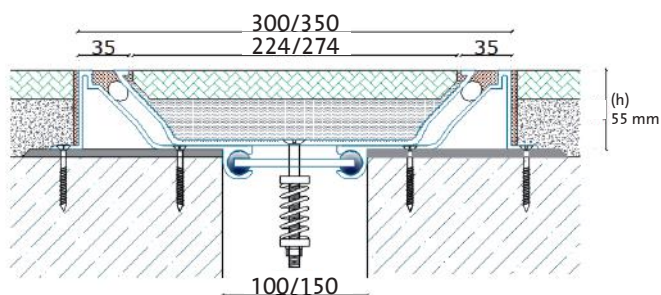

Indications

The following applies to all products/materials: Usability in terms of mechanical and chemical loads should be carefully checked in each case before installation.

DURAL GmbH

Südring 11
D-56412 Ruppach-Goldhausen
Tel. +49 (0) 2602/9261-0
Fax +49 (0) 2602/9261-50
info@dural.com

Product Data Sheet

DURAFLEX Z 40RF

Heavy-duty aluminium expansion joint profile for mounting on the floor covering



The expansion joint profile DURAFLEX Z 40 RF is made entirely of high quality aluminium and is designed for areas with high stress and traffic loads, including outdoors. Fields of application are car parks as well as commercial or industrial buildings. The profiles are retrofitted to the floor covering. In version Z 40, the profile is available for integration into the floor covering.



Technical Properties

Item-no. Floor/Floor connection DFA Z40RF .../400 Floor/Wall connection DFA Z40RF ...X/400	10014
Overall joint gap	100 mm
Visible width (floor/floor)	240 mm
Nominal height (h)	14 mm
Load bearing capacity	60kN vehicle, 15kN forklift
Movement capacity	24 mm (± 12 mm)
Profile length	400 cm
Material	Aluminium
Anchorage	Every 35 cm

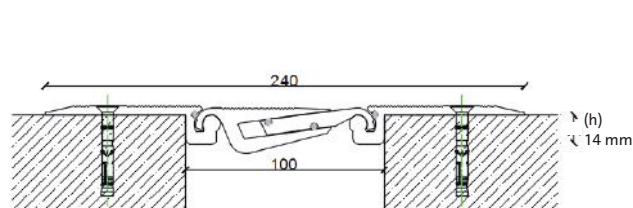

Floor/Floor connection

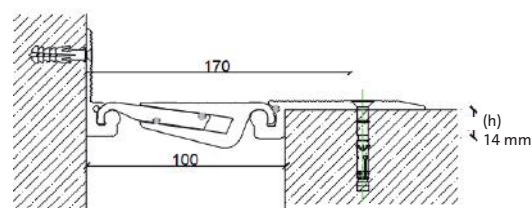

Floor/Wall connection

Indications

The following applies to all products/materials: Usability in terms of mechanical and chemical loads should be carefully checked in each case before installation.

DURAL GmbH

Südring 11
 D-56412 Ruppach-Goldhausen
 Tel. +49 (0) 2602/9261-0
 Fax +49 (0) 2602/9261-50
 info@dural.com

Product Data Sheet

DURAFLEX Z 50RF

Expansion joint profile made of aluminium for mounting on the floor covering



The DURAFLEX Z 50RF expansion joint profile is made entirely of high quality aluminium and is designed for outdoor areas with light stress and traffic loads. Areas of application include floors of shopping malls, schools or hotels, but also car parks that are only used by light vehicles. The profiles are retrofitted onto the floor covering. In version Z 50, the profile is available for integration into the floor covering.



Pedestrian



Interior

Technical Properties

Item-no.		
Floor/Floor connection	DFA Z50RF .../300	10026
Floor/Wall connection	DFA Z50RF ...X/300	
Overall joint gap		100 mm
Visible width (floor/floor)		200 mm
Nominal height (h)		26 mm
Load bearing capacity		Pedestrian
Movement capacity		30 mm (± 15 mm)
Profile length		300 cm
Material		Aluminium
Anchorage		Every 35 cm

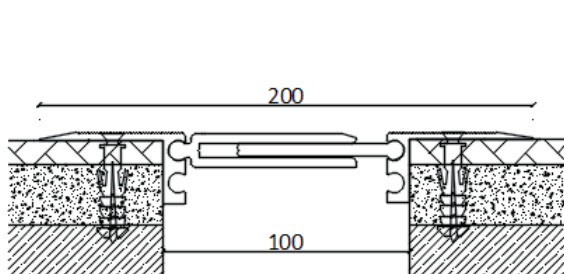

Floor/Floor connection

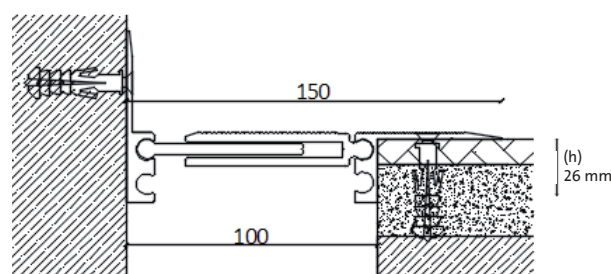

Floor/Wall connection

Indications

The following applies to all products/materials: Usability in terms of mechanical and chemical loads should be carefully checked in each case before installation.

DURAL GmbH

Südring 11
D-56412 Ruppach-Goldhausen
Tel. +49 (0) 2602/9261-0
Fax +49 (0) 2602/9261-50
info@dural.com

Product Data Sheet

DURAFLEX Z 30

Z 30 - Aluminium expansion joint profile for installation in the floor covering (integrated)



The aluminium composite Z 30 expansion joint profiles with thermoplastic elastomer inserts are designed for use in shopping malls, houses, apartments, schools or hotels used by pedestrians. The version for 100 mm joint width can also be used in places used by light vehicles, such as in multi-storey car parks. The profiles are built into the floor covering and are available for three different floor covering heights.



Technical Properties

Item-no. Floor/Floor connection DFA Z30 .../300 Floor/Wall connection DFA Z30 ...X/300	10043 10060
Overall joint gap	100 mm
Visible width (floor/floor)	120 mm
Nominal height (h)	43 mm 60 mm
Load bearing capacity	30kN vehicle, 15kN forklift
Movement capacity	28 mm (± 14 mm)
Profile length	300 cm
Material	Aluminium, TPE
Anchorage	Every 35 cm

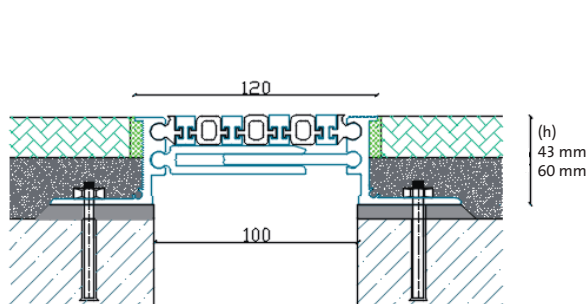

Floor/Floor connection

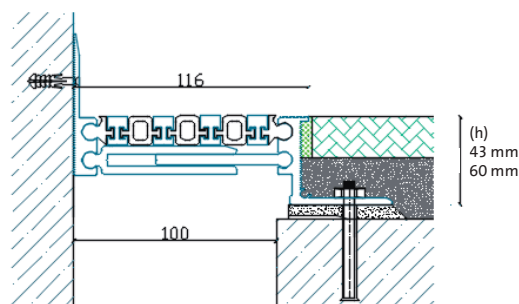

Floor/Wall connection

Indications

The following applies to all products/materials: Usability in terms of mechanical and chemical loads should be carefully checked in each case before installation.

DURAL GmbH

Südring 11
 D-56412 Ruppach-Goldhausen
 Tel. +49 (0) 2602/9261-0
 Fax +49 (0) 2602/9261-50
 info@dural.com

Product Data Sheet

DURAFLEX Z 100

Expansion joint profile made of aluminium / TPE / stainless steel for installation in the floor covering (integrated)



The DURAFLEX Z 100 expansion joint profile is designed for use in areas with high traffic loads and the need for sealing the substrate against penetrating moisture also in the area of the expansion joints. Fields of application include multi-storey car parks and commercial or industrial buildings, and also outdoors. The base profiles are made of aluminium; the seal and the motion absorption area are made of sturdy thermoplastic elastomer. The covers are made of stainless steel (316).



Technical Properties

Item-no.		
Floor/Floor connection	DFA Z100 .../300	10070
Floor/Wall connection	DFA Z100 ...X/300	
Overall joint gap		100 mm
Visible width (floor/floor)		130 mm
Nominal height (h)		70 mm
Load bearing capacity		90kN vehicle, 35kN forklift
Movement capacity		40 mm (± 20 mm)
Profile length		300 cm
Material		Aluminium, TPE, stainless steel (316)
Anchorage		Every 35 cm

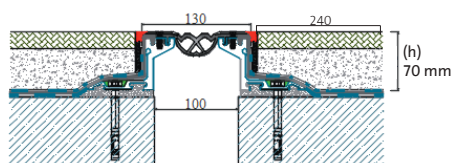

Floor/Floor connection

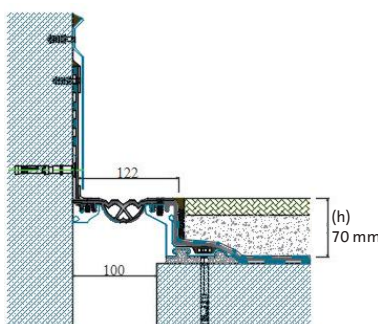

Floor/Wall connection

Indications

The following applies to all products/materials: Usability in terms of mechanical and chemical loads should be carefully checked in each case before installation.

DURAL GmbH

Südring 11

D-56412 Ruppach-Goldhausen

Tel. +49 (0) 2602/9261-0

Fax +49 (0) 2602/9261-50

info@dural.com

Product Data Sheet

DURAFLEX Z 160RF

Expansion joint profile made of steel / rubber for retrofitting onto the floor covering



The DURAFLEX Z160RF expansion joint profile is a particularly flat, highly resilient system for retrofitting onto the floor covering. Fields of application are car parks, shopping malls or industrial buildings, including outdoors. The steel core is completely encased in rubber. The anchoring in the floor is unilateral.



Industrial



Heavy Vehicle



Exterior/Interior

Technical Properties

Item-no.		
Floor/Floor connection	DFR Z160RF .../200	5008
Floor/Wall connection	DFR Z160RF .../200	1008
Overall joint gap	50 mm	100 mm
Visible width (floor/floor)	200 mm	250 mm
Nominal height (h)	8 mm	8 mm
Load bearing capacity	90kN vehicle, 90kN forklift	90kN vehicle, 90kN forklift
Movement capacity	100 mm (\pm 50 mm)	100 mm (\pm 50 mm)
Profile length	200 cm	200 cm
Material	Rubber, steel	Rubber, steel
Anchorage	Every 25 cm	Every 25 cm

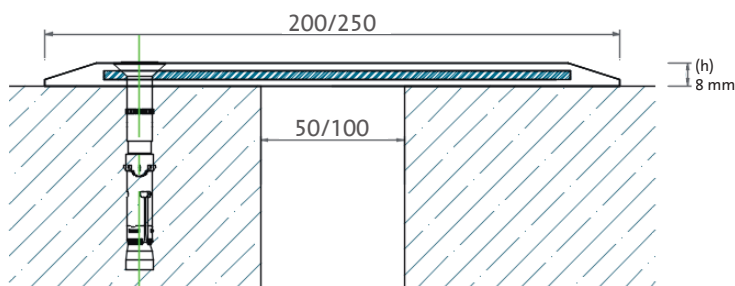

Indications

The following applies to all products/materials: Usability in terms of mechanical and chemical loads should be carefully checked in each case before installation.

DURAL GmbH

Südring 11
D-56412 Ruppach-Goldhausen
Tel. +49 (0) 2602/9261-0
Fax +49 (0) 2602/9261-50
info@dural.com



Product Data Sheet

DURAFLEX Z 130RF

Expansion joint profile made of steel / rubber for mounting on the floor covering



The DURAFLEX Z 130RF expansion joint system is designed for retrofitting on floors in shopping centres or car parks, including with heavy traffic, and also outdoors. The steel core is completely encased in rubber. It is available for different joint widths.



Heavy Vehicle Exterior/Interior

Technical Properties

Item-no. DFR Z130RF .../200	5035	10035
Overall joint gap	50 mm	100 mm
Visible width (floor/floor)	312 mm	362 mm
Nominal height (h)	35 mm	35 mm
Load bearing capacity	65kN vehicle	65kN vehicle
Movement capacity	50 mm (±25 mm)	100 mm (±50 mm)
Profile length	200 cm	200 cm
Material	Rubber, steel	Rubber, steel
Anchorage	Every 25 cm	Every 25 cm

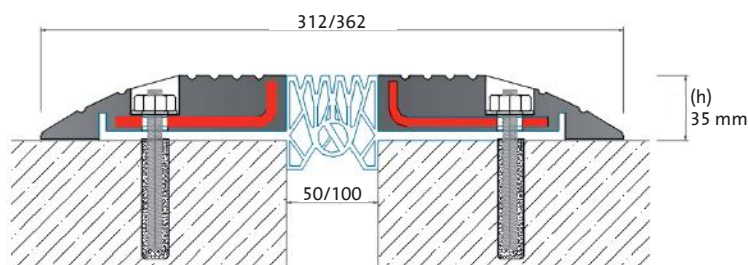

Indications

The following applies to all products/materials: Usability in terms of mechanical and chemical loads should be carefully checked in each case before installation.

DURAL GmbH

Südring 11
D-56412 Ruppach-Goldhausen
Tel. +49 (0) 2602/9261-0
Fax +49 (0) 2602/9261-50
info@dural.com



Product Data Sheet

DURAFLEX Z 90

Seismic expansion joint profile for installation in the floor covering (integrated)

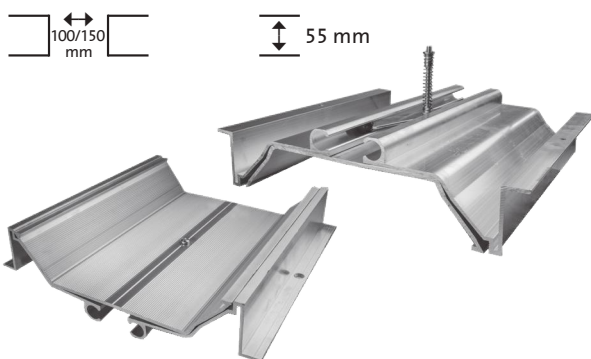

The expansion joint profiles of the DURAFLEX Z 90 series have been specially developed for use in shopping malls, houses, flats, schools, hotels and other buildings where there is a risk of seismic vibrations. The profile, made entirely of high quality aluminium, is installed in the floor covering and is designed for areas with light pedestrian loads.



Technical Properties

Item-no. DFA Z90 .../300	10055	15055
Overall joint gap	100 mm	150 mm
Visible width (floor/floor)	300 mm	350 mm
Nominal height (h)	55 mm	55 mm
Load bearing capacity	Pedestrian	Pedestrian
Movement capacity	100 mm (±50 mm)	150 mm (±75 mm)
Profile length	300 cm	300 cm
Material	Aluminium	Aluminium
Anchorage	Every 35 cm	Every 35 cm

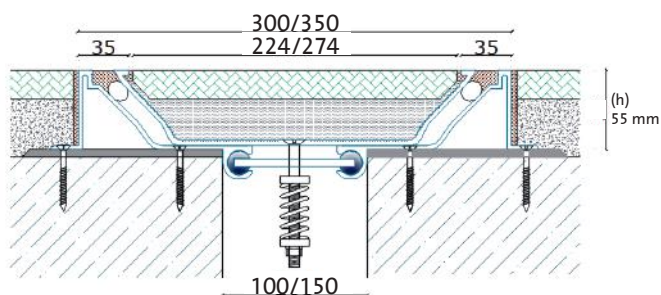

Indications

The following applies to all products/materials: Usability in terms of mechanical and chemical loads should be carefully checked in each case before installation.

DURAL GmbH

Südring 11
D-56412 Ruppach-Goldhausen
Tel. +49 (0) 2602/9261-0
Fax +49 (0) 2602/9261-50
info@dural.com

Product Data Sheet

DURAFLEX Z 30

Z 30 - Aluminium expansion joint profile for installation in the floor covering (integrated)



The aluminium composite Z 30 expansion joint profiles with thermoplastic elastomer inserts are designed for use in shopping malls, houses, apartments, schools or hotels used by pedestrians. The version for 100 mm joint width can also be used in places used by light vehicles, such as in multi-storey car parks. The profiles are built into the floor covering and are available for three different floor covering heights.



Pedestrian



Exterior/Interior

Technical Properties

Item-no.	
Floor/Floor connection	DFA Z30 .../300
Floor/Wall connection	DFA Z30 ...X/300
	15028 15043 15060
Overall joint gap	150 mm
Visible width (floor/floor)	160 mm
Nominal height (h)	28 mm 43 mm 60 mm
Load bearing capacity	Pedestrian
Movement capacity	70 mm (±35 mm)
Profile length	300 cm
Material	Aluminium, TPE
Anchorage	Every 35 cm

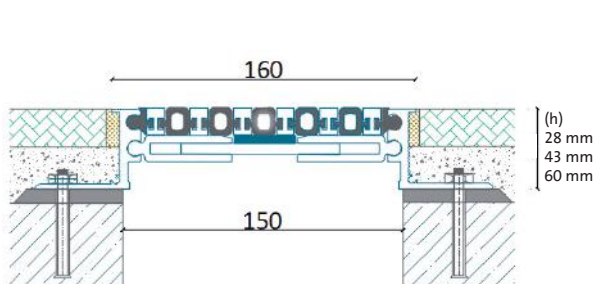

Floor/Floor connection

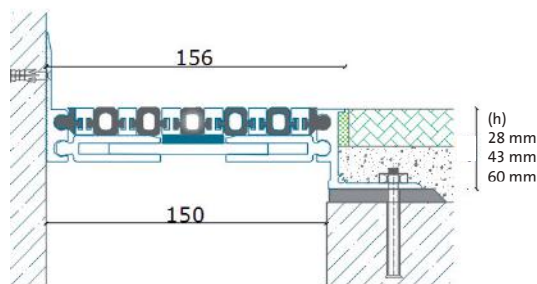

Floor/Wall connection

Indications

The following applies to all products/materials: Usability in terms of mechanical and chemical loads should be carefully checked in each case before installation.

DURAL GmbH

Südring 11
D-56412 Ruppach-Goldhausen
Tel. +49 (0) 2602/9261-0
Fax +49 (0) 2602/9261-50
info@dural.com

Product Data Sheet

DURAFLEX D 10RF

Expansion joint profile for walls and ceilings made of aluminium / TPE for mounting on the covering



The DURAFLEX D 10RF series aluminium expansion joint profiles with a thermoplastic elastomer insert for absorbing movement are specially designed for retrofitting on walls and ceilings in hospitals, shopping malls or offices. Examples of suitable substrates are concrete, tiles or plasterboard. The profiles are available in different widths.



Technical Properties

Item-no. Wall/Wall connection DFA D10RF .../300 Wall/Ceiling connection DFA D10RF ...X/300	3012
Overall joint gap	30 mm
Visible width (wall/wall)	125 mm
Nominal height (h)	12 mm
Movement capacity	20 mm (± 10 mm)
Profile length	300 cm
Material	Aluminium, TPE
Anchorage	Every 45 cm

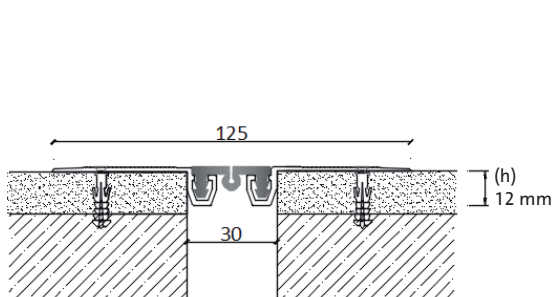

Wall/Wall connection

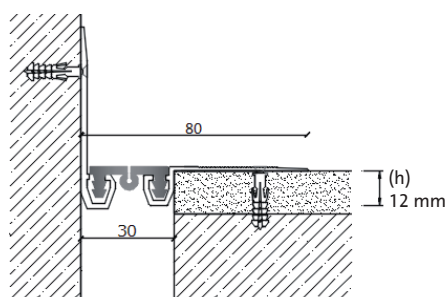

Wall/Ceiling connection

Indications

The following applies to all products/materials: Usability in terms of mechanical and chemical loads should be carefully checked in each case before installation.

DURAL GmbH

Südring 11
 D-56412 Ruppach-Goldhausen
 Tel. +49 (0) 2602/9261-0
 Fax +49 (0) 2602/9261-50
 info@dural.com

Product Data Sheet

DURAFLEX D 10RF

Expansion joint profile for walls and ceilings made of aluminium / TPE for mounting on the floor covering



The DURAFLEX D 10RF series aluminium expansion joint profiles with a thermoplastic elastomer insert for absorbing movement are specially designed for retrofitting on walls and ceilings in hospitals, shopping malls or offices. Examples of suitable substrates are concrete, tiles or plasterboard. The profiles are available in different widths.



Technical Properties

Item-no.		
Wall/Wall connection	DFA D10RF .../300	5012
Wall/Ceiling connection	DFA D10RF ...X/300	
Overall joint gap		50 mm
Visible width (wall/wall)		145 mm
Nominal height (h)		12 mm
Movement capacity		20 mm (± 10 mm)
Profile length		300 cm
Material		Aluminium, TPE
Anchorage		Every 45 cm

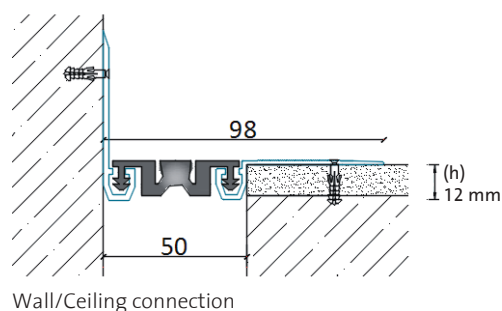
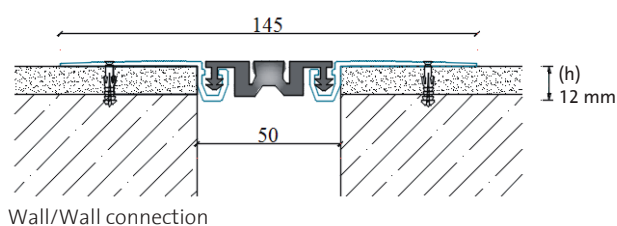

Indications

The following applies to all products/materials: Usability in terms of mechanical and chemical loads should be carefully checked in each case before installation.

DURAL GmbH

Südring 11
D-56412 Ruppach-Goldhausen
Tel. +49 (0) 2602/9261-0
Fax +49 (0) 2602/9261-50
info@dural.com



Product Data Sheet

DURAFLEX FIRE-FLEX

Expansion joint tape



Description

DURAFLEX FIRE-FLEX is a flexible joint sealing cord in fire class A1 in accordance with DIN13501-1 made from mineral fibres with a glass fibre braid. This fire protection product for construction is ideal for equipping or upgrading all joints in a structure with fire protection technology so as to achieve a fire resistance duration of a minimum of 240 minutes.

Standard sizes (rolls)	Standard sizes XL (rolls)	Standard sizes XXL (rolls)
DFF 12/20	DFF 70/20	DFF 120/1
DFF 20/20	DFF 80/10	DFF 150/1
DFF 30/20	DFF 90/10	DFF 160/1
DFF 40/20	DFF 100/10	DFF 180/1
DFF 50/20		
DFF 60/20		

*(Diameter / m per roll)

- Approved system in class A1 in accordance with EN 13501-1 for fire-resistant partitioning in building joints with a joint width of 10 – 150 mm that has ETA approval!
- Can be delivered in fourteen dimensions from 12 – 180 mm!
- For A1 fire protection joints with 240 minutes (4 hrs) of fire resistance E1240.
- With just single-layer plugging for static joints with up to 7.5 % movement absorption and joint widths of 10 – 150 mm – E1240 – 240 minutes of fire resistance (wall horizontal and vertical).
- Highest ever tested and approved fire resistance classification E1240 with only single-layer plugging in static joints.
- Maximum two-layer plugging for all expansion and movement joints with up to 20 % movement absorption and a joint width of 10 – 100 mm E1240 – 240 minutes of fire resistance (wall horizontal and vertical) in all joint dimensions and installation situations. No 3 or 4-layer plugging necessary, thus efficient and more cost-effective implementation of fire resistant partitioning.
- 40-year minimum service life of the fire-resistant partitioning.

Indications

The following applies to all products/materials: Usability in terms of mechanical and chemical loads should be carefully checked in each case before installation.

DURAL GmbH

Südring 11

D-56412 Ruppach-Goldhausen

Tel. +49 (0) 2602/9261-0

Fax +49 (0) 2602/9261-50

info@dural.com



Product Data Sheet

DURAFLEX TAPE

Expansion Joint Tape



Description

DURAFLEX TAPE is a thermoplastic elastomer based dilatation tape which is used for insulation and closure of wall-floor junctions and all types of structure and expansion joints.

Technical Properties

Item-no.	DFT 15/25	DFT 25/25	DFT 35/25
	DFT 20/25	DFT 30/25	DFT 40/25
Material	thermoplastic elastomer		
Width	15 - 20 - 25 - 30 - 35 - 40 cm		
Appearance	gray colored, sides with holes		
Thickness	1,25 mm \pm 0,25		
Weight	1,4 g/cm ²		
Shore a hardness	70		
Explosion pressure	4 bar		
Water pressure strenght	3 bar		
Widthwise rupture	% 1050		
Lenghtwise rupture	% 460		
Rupture strenght	14 N/mm ²		
Heat resistance	-50°C / +90°C		
Packaging	Roll 25 m		
Shelf life	No limit from production date under suitable storing conditions.		

Advantages

- Easy to apply
- Suitable for welding by heat
- Provides permanent insulation
- It has high elasticity
- Does not lose its elasticity because of cold
- High resistant to tearing
- Resistant to bacterial attacks and chemical breaking
- High resistance against environmental factors and aggressive mediums
- Resistant to ozone and UV
- Ensuring safe insulation at dilatation joints together with mastics
- Water insulation and compensation of movements on dynamic cracks and cold joints of floors and curtains

Area of Use

- Underground applications
- Foundations and curtains
- Pools
- Treatment plants
- Tunnel segments
- Balconies and parapets
- Terraces and roof edges

Indications

The following applies to all products/materials: Usability in terms of mechanical and chemical loads should be carefully checked in each case before installation.

DURAL GmbH

Südring 11

D-56412 Ruppach-Goldhausen

Tel. +49 (0) 2602/9261-0

Fax +49 (0) 2602/9261-50

info@dural.com



DURAL GmbH
Südring 11
D-56412 Ruppach-Goldhausen
Tel. +49 (0) 2602/9261-0
Fax +49 (0) 2602/9261-50
info@dural.com